

INNER-GROOVED TUBES - STANDARD GENERATION

Inner-grooved tubes of KobeWieland are widely used in a broad spectrum of industries. KobeWieland has developed a second generation of inner-grooved tubes which provides higher performance, reduced unit weights and are optimized for environmentally friendly refrigerants.

Description of tubes: Level Wound Coils
C-12200
Light Annealed*
Bulk Packed/E2S (ID-payoff)/Cardboard Reels*
Full Coils with approx. 460 lbs*
ASTM*

* For other configurations, sizes and coil weights, please contact KobeWieland

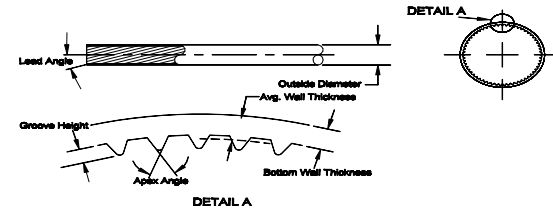

Tube Type *			Outside Diameter		Approximate Inside Diameter		Average Wall Thickness		Bottom Wall Thickness (bwt)		Groove Height		Lead Angle	No. of Grooves	Approximate Unit Weight	
			inch	mm	inch	mm	inch	mm	inch	mm	inch	mm			lb/ft	g/m
7.00 mm x	0.0098" bwt	C-50	0.2756	7.00	0.2417	6.14	0.0118	0.30	0.0098	0.25	0.0071	0.18	18	50	0.03830	57.00
7.00 mm x	0.0118" bwt	C-50	0.2756	7.00	0.2378	6.04	0.0138	0.35	0.0118	0.30	0.0071	0.18	18	50	0.04435	66.00
5/16" x	0.0110" bwt	C-50	0.3125	7.94	0.2748	6.98	0.0134	0.34	0.0110	0.28	0.0079	0.20	18	50	0.04897	72.87
5/16" x	0.0118" bwt	C-50	0.3125	7.94	0.2732	6.94	0.0142	0.36	0.0118	0.30	0.0079	0.20	18	50	0.05174	77.00
5/16" x	0.0122" bwt	C-50	0.3125	7.94	0.2724	6.92	0.0146	0.37	0.0122	0.31	0.0079	0.20	18	50	0.05313	79.06
5/16" x	0.0140" bwt	C-50	0.3125	7.94	0.2688	6.83	0.0165	0.42	0.0140	0.356	0.0079	0.20	18	50	0.05938	88.37
5/16" x	0.0160" bwt	C-50	0.3125	7.94	0.2646	6.72	0.0185	0.47	0.0160	0.41	0.0079	0.20	18	50	0.06675	99.33
3/8" x	0.0117" bwt	C-60	0.3750	9.52	0.3359	8.53	0.0142	0.36	0.0117	0.297	0.0079	0.20	18	60	0.06202	92.30
3/8" x	0.0118" bwt	C-60	0.3750	9.52	0.3356	8.52	0.0142	0.36	0.0118	0.300	0.0079	0.20	18	60	0.06250	93.01
3/8" x	0.0126" bwt	C-60	0.3750	9.52	0.3341	8.48	0.0150	0.38	0.0126	0.32	0.0079	0.20	18	60	0.06586	98.01
3/8" x	0.0130" bwt	C-60	0.3750	9.52	0.3333	8.46	0.0154	0.39	0.0130	0.33	0.0079	0.20	18	60	0.06753	100.50
3/8" x	0.0134" bwt	C-60	0.3750	9.52	0.3325	8.44	0.0157	0.40	0.0134	0.34	0.0079	0.20	18	60	0.06920	102.99
3/8" x	0.0160" bwt	C-60	0.3750	9.52	0.3270	8.30	0.0185	0.47	0.0160	0.41	0.0079	0.20	18	60	0.08080	120.24
1/2" x	0.0126" bwt	C-75	0.5000	12.70	0.4551	11.56	0.0160	0.41	0.0126	0.32	0.0098	0.25	18	75	0.09610	143.01
1/2" x	0.0160" bwt	C-75	0.5000	12.70	0.4480	11.38	0.0200	0.51	0.0160	0.41	0.0098	0.25	18	75	0.11643	173.27
1/2" x	0.0169" bwt	C-65	0.5000	12.70	0.4465	11.34	0.0210	0.53	0.0169	0.43	0.0098	0.25	18	65	0.11911	177.26
1/2" x	0.0236" bwt	A-72	0.5000	12.70	0.4370	11.10	0.0276	0.70	0.0236	0.60	0.0079	0.20	25	72	0.15895	236.54
5/8" x	0.0200" bwt	C-60	0.6250	15.88	0.5612	14.26	0.0244	0.62	0.0201	0.51	0.0118	0.30	27	60	0.17108	254.60
5/8" x	0.0248" bwt	C-60	0.6250	15.88	0.5518	14.02	0.0291	0.74	0.0248	0.63	0.0118	0.30	27	60	0.20445	304.26
5/8" x	0.0228" bwt	C-75	0.6250	15.88	0.5557	14.12	0.0280	0.71	0.0228	0.58	0.0118	0.30	22	75	0.19641	292.29
5/8" x	0.0299" bwt	C-60	0.6250	15.88	0.5415	13.76	0.0350	0.89	0.0299	0.76	0.0118	0.30	27	60	0.23999	357.14